

datacomet.com/ or DATABASEAST.COM/
primary web page...

dataComet

Fast, flexible, reliable, high quality terminal emulation for the Macintosh:

- Compatible with Mac OS X 10.2 and above, including Lion.
- VT100, VT220, VT320 emulation for Linux, UNIX & VMS systems.
- PC-ANSI + SCO-ANSI emulation with custom PC-ANSI fonts.
- IBM-3279/5250 terminal emulation for IBM enterprise and AS/400 systems.
- Supports Shell, Telnet, and Serial connections.
- Support for inline SCP, ZMODEM, and IBM IND\$FILE file transfers, with automatic translation (Binhex, MacBinary) and document launching.
- Multiple window interface supports many host sessions. Built-in text windows allow host commands to be sent to a session with a single right-click.
- Flexible and easy to use key remapping facility.
- Extensive scriptability using built-in macro language and AppleScript.
- "Watch Me" macro recording for simplified session scripting.
- On-screen buttons to send text and execute macro commands.
- Customizable color maps.
- Flexible translation for multinational character set support.
- Modeless Preferences dialogs.
- On-line documentation: Control-Click or Control-Menu Select displays documentation for dialog and menu items.

dataComet-Secure

All the outstanding features of dataComet plus added security:

- Secure Telnet/TN3270 connections using SSL/TLS or Kerberos 5 authentication and encryption.
- Secure SSH (Secure Shell) sessions, supporting SSH version 1 and 2.
- SSH password authentication (and RSA when using SSH1.5)
- DES, 3-DES, and Blowfish encryption & zlib compression option
- SSH sessions can be configured to execute a remote command and exit.
- Secure file transfers using SCP over SSH sessions.
- Safe encryption of passwords in local session documents using a master passphrase to enable automatic logins.



BLAYK, BONZE ANNE ROSE
A00082793308 M000597460
05/01/1956 60 F
Ehmke, Clifford BSU 202-01



I have definitely, in terms of real-world accomplishment in the innovative creation and application of novel algorithms, attained an equivalent to a Ph.D. in Computer Science / Networked Systems.

Sincerely,
Bonze Blayk

1/22/07

Bonze Anne Rose Blayk

See "Drew's Picks" page 4 for his strong recommendation
of dataComet - Bonze Dayk - 1/22/17

118

The Mac Orchard

Essential Internet Applications for Macintosh Users Since 1995

Home • Help • FAQ

ALEMIA • Forums • Drew's Picks

Drew's Picks 



BLAYK, BONZE ANNE ROSE
A00082793308 M000597460
05/01/1956 60 F
Ehmke, Clifford BSU 202-01
Application Types

Introduction

While all the software listed on the Orchard is essential in one form or another, there are certain applications that I find myself recommending time and time again to Mac users who haven't had the luxury of exploring all of what The Mac Orchard covers. Historically, I have awarded a "Essential Golden Apple" badge to these applications to help signify their unique status. In the 2005 redesign of the Orchard, however, I altered this designation to help clarify what these offerings really were: my personal preferences in the Internet applications I use (or have used) on a regular basis, and which I choose to recommend to others when asked. Today, I refer to these as "Drew's Picks."

"Drew's Picks" are still signified by golden apples to the left of an application's name in its listing. These apples, where they appear, indicate programs that have proven their value, time after time, to myself and countless others. Without these programs, the Macintosh Internet experience would not be what it is today, and the authors who create this software deserve special recognition. This is my way of giving it to them. This page attempts to clarify my current picks, and I hope it's especially useful to people who are new to the Macintosh and are looking to get started with some great Internet software.

There are also a few applications in some categories that seem headed toward "essential" status, and I have called these out in text as "Rising Stars." These programs are also worthy of your consideration, but they are generally undergoing considerable development, and may not have settled into a routine, long-term pattern of robust, reliable behavior that I expect in a "Drew's Pick."

I ask my dear readers, however, to keep one thing in mind when perusing this page: **these are only my opinions, offered up for your consideration**. They are opinions informed by over a decade of experience, but they are opinions nonetheless. I encourage you to explore the Orchard and develop your own opinions, and I welcome you to share those opinions with me so that I can use those to help flesh out each application's listing on the Orchard.

On a related note, this list does **not** include every category of application that The Mac Orchard covers. Rather, it is limited to the types of software that the vast majority of Internet users require for their basic "toolbox," which includes email clients, file transfer applications, IRC clients, networking

applications, terminal emulators, and Usenet newsreaders (with a few others thrown in for good measure).

These "Picks" do change from time to time, so feel free to return here occasionally to see what my current thoughts are on my own personal "cream of the crop." This page saw its last substantial edits on December 15, 2005.

Email

Drew's Pick: [Eudora](#)



BLAYK, BONZE ANNE ROSE
A00082793308 M000597460
05/01/1956 60 F
Ehmke, Clifford BSU 202-01

Please note: I actually use Apple Mail myself these days, but I keep this recommendation here as a protest against the key features that I think Apple Mail is lacking.

The selection of an email program is a very personal decision, and I hesitate to foist any one program on a complete stranger. Recommending an email program requires knowing quite a bit about individual personality traits and workflow needs. That said, there are some characteristics that generally bring people to The Mac Orchard, and one of them is that Orchard visitors (and that just might include **you!**) generally want to explore Internet software that is "outside the box" – that is, software that can support more sophisticated needs than what comes preinstalled on your machine.

From that standpoint, there is only one email program that deserves a look from **every** Mac user with more than basic email needs, and that's [Eudora](#). Eudora can handle just about any requirement that is thrown at it, whether via its [extensive preferences](#) or through a [wide variety of plug-ins](#). The only thing Eudora has working against it is its user interface, which is indeed dated (although the [Penelope](#) project aims to address that). But functionality trumps aesthetics for many needs, and Eudora delivers that in droves.

In other words, while email needs vary wildly, you owe it to yourself to try Eudora at some point, even if another program winds up suiting your particular needs better.

As an aside, you might notice that I don't cover Mac OS X's built-in "Mail" application on The Mac Orchard. There are a few reasons for this, the principal reason being that Apple does not make *any* version of Mail available for download (it's only bundled with Mac OS X); this cannot be said of most of Apple's other Internet applications. If Apple did make Mail available at some point as a separate download, there is no doubt that I would include it on the Orchard. Other reasons include some of Mail's other shortcomings, like its inability to offer user-defined stationery, and its inability to easily hand-categorize incoming messages.

Rising Star: [Apple Mail](#), [Thunderbird](#)

FTP

Drew's Picks: [Fetch](#), [Interarchy](#), [Transmit](#)

As with email, FTP client selection depends very much upon one's workflow needs. What's great for one person might not be right for another, and what's good for one person on one project might not be the right tool for the very same person working on another project.

This is why I recommend – and actually use – three different FTP clients for the Mac, each of which has its own niche:

- [Fetch](#) is really the most essential Mac FTP utility of all. It runs equally well on "Classic" Mac OS and Mac OS X, provides incredible ease-of-use, and has all of the features that most people with basic FTP needs really require. It is *the* FTP tool to give graphic designers to enable them to share files with clients.
- [Interarchy](#) is one of the most vital pieces of Macintosh Internet software, period. It's much more than an FTP client. It's a network analyzer/web page link checker/FTP/HTTP transfer agent/and more, all wrapped up in one beautiful package. It's *the* tool to use if you want to manage http-based downloads while maintaining your sanity. It's also *the* tool to give web designers who need to help debug web site issues. But it's also an insanely powerful tool that can be daunting for the average user.
- [Transmit](#) sits somewhere between Fetch and Interarchy. Its feature set is not quite as exhaustive as Interarchy's, yet it offers some sophistication that Fetch lacks, while keeping a relatively straightforward (even attractive) user interface. Transmit has always been especially worthy of consideration if you use SFTP on a regular basis and prefer to manage SSH/SFTP connections using Mac OS X's centralized "sshconfig" capability rather than in separate, standalone applications. In other words, if you have an SSH host's information (such as a public key) already specified in your system-wide (or user-wide) SSH configuration files, Transmit will use that information to access remote hosts without requiring you to store additional information within the application itself. In early 2006, however, [Interarchy](#) and [Yummy FTP](#) added this capability as well.

Rising Star: [Yummy FTP](#)

Internet Relay Chat

Drew's Picks: [Ircle](#), [Snak](#)



4/8

In the spirit of full disclosure, I must admit that I am not an IRC user. However, IRC users are a picky lot, and [Ircle](#) and [Snak](#) are head-and-shoulders above the rest of the Mac IRC client offerings. If you are serious about IRC, these are the two programs you'll want to download and try out first.

Rising Star: [Colloquy](#)

Networking

Drew's Picks: [Interarchy](#), [IPNetMonitor](#), [IPNetRouter](#), [IPNetSentry](#), [IPNetTuner](#), [WhatRoute](#)

Not only is [Interarchy](#) a stupendous FTP tool; it's a tool any webmaster will want in his or her belt to assist with common network analysis issues that crop up from time to time, like port scans, traceroutes, DNS issues, and more. Most critically, it works in conjunction with [pcap](#) to help you monitor web TCP/IP traffic coming into and out of your machine, which is incredibly essential for hardcore web development debugging. In this sense, it natively performs a function on the Macintosh that Windows and other UNIX users have access to in the excellent [Ethereal](#) application, which also provides a graphical front end to pcap. This functionality alone is worth the price of admission, yet [Interarchy](#) is so much more.

Aside from [Interarchy](#), all of Sustainable Softworks' core tools (whose names share the telltale "IPNet..." prefix) are essential in their own right. Sustainable's Peter Sichel is a [critical figure in the Mac Internet community](#), and the software-based tools his company produces are absolutely top-notch, offering fantastic bang for the buck

Finally, [WhatRoute](#) is really the only free traceroute application with mapping support for the Mac, and it works quite well.

Terminal Emulation

Drew's Picks: [dataComet](#), [dataComet-Secure](#)

Terminal emulators are essential if you have remote machines – such as library card catalog systems and UNIX/Linux/Mac OS X machines – that you want to access from your Mac.

Mac OS X has a useful series of standard UNIX terminal emulation services (including telnet and ssh clients) built-in, but if you need to go beyond simple "vt100"-type telnet access, you'll definitely want something more, and there is an [awful lot to choose from](#).

However, without hesitation, I recommend DataBeast's [dataComet](#) series of terminal emulators – available for both "Classic" Mac OS as well as Mac OS X – which support both "VT" series and IBM 327x emulation that is essential for accessing IBM mainframes. Yes, you can download multiple pieces of free



BLAYK, BONZE ANNE ROSE
A00082793308 M000597460
05/01/1956 60 F
Ehmke, Clifford BSU 202-01

software separately to gain most of dataComet's functionality, but you won't get all of dataComet's really cool features like AppleScript support, incredibly extensive preferences, and much much more.

Usenet Newsreaders

Drew's Picks: [Multi-Threaded NewsWatcher](#), [NewsWatcher](#), [Yet Another NewsWatcher](#)

As with email clients, Usenet newsreader selection involves consideration of a wide variety of very personal factors. That said, the Macintosh world is fortunate to have a variety of newsreaders that are among the best available on *any* platform. Some of these newsreaders have features that the original creators of the Usenet probably never envisioned – like Simon Fraser's superb [Multi-Threaded NewsWatcher](#), which offers such niceties as scroll wheel-based thread navigation and spam filtering.

The NewsWatcher series of Usenet newsreaders – which centers around with John Norstad's ("Classic" Mac OS-only) original [NewsWatcher](#) client – have such wonderfully thought out features and interfaces that it's difficult for me to imagine reading news any other way. Derivatives of John's original program – which include the now-defunct but still downloadable [Yet Another NewsWatcher](#) – have sparked countless debates over the past decade.

The only NewsWatcher derivative that is still actively supported (and works natively on Mac OS X) is [Multi-Threaded NewsWatcher](#), which provides a classic multiple-window Macintosh user interface that I (and countless others) find very comforting and eminently usable. However, all three of these applications deserve a look if you are at all serious about reading Usenet newsgroups.

Rising Star: [Unison](#)

Web Browsers

Drew's Picks: [Firefox](#), [Safari](#)

For all of their importance as critical Internet applications, web browsers are somewhat simpler beasts than email, FTP, and newsreading applications. A browser's *primary* job is merely to provide a window onto what are, essentially, other applications. Good web browsers must do five things well:

BLAYK, BONZE ANNE ROSE
A00082793308 M000597460
05/01/1956 60 F
Ehmke, Clifford BSU 202-01

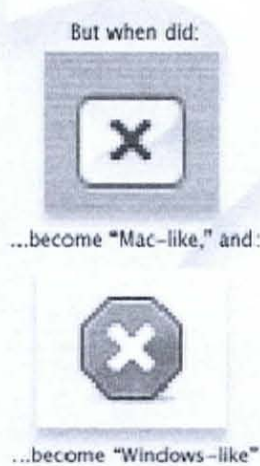

- Render as many web sites as possible in the manner in which their creators intended;
- Perform these rendering services as quickly as possible;
- Provide adequate security and privacy features to protect users from evildoers;
- Provide for seamless organization and navigation through the mountains of information that a web browsing session can quickly conjure up;
- Act robustly and reliably so that the end user can concentrate on interacting with web sites rather than with the program itself.

For Mac OS X, there are two programs that bring these things together with near-perfect choreography: Apple's [Safari](#) and Mozilla [Firefox](#). I personally prefer the latter for the reasons that I discuss at length on the [Firefox page](#) (i.e., by using and supporting Firefox, you help foster a more egalitarian, platform-agnostic take on the Web, which is what the Web is really all about), but I occasionally use Safari with certain JavaScript-intensive sites because Safari's JavaScript performance is frankly better than Firefox's for certain tasks.

Here's one final bewildering thought. For some strange reason, there are a number of people who maintain that Safari is somehow more "Mac-like" while Firefox is somehow more "Windows-like." This makes me wonder: *just where along the line did our collective perception of "Mac-like" get out of whack?* To this, I can only pose the puzzlement pictured herein for your consideration...

Rising Star: [Opera](#)

Other Applications



BLAYK, BONZE ANNE ROSE
 A00082793308 M000597460
 05/01/1956 60 F
 Ehmke, Clifford BSU 202-01

Drew's Picks: [JollysFastVNC](#), [WeatherDock](#), [Skim](#), [Internet Config](#)

The following applications fit into the Orchard's "Other" applications category, which is to say that they do not serve or receive information via any particular standardized protocol or perform any widely standardized task. These happen to include a wide variety of applications that includes the following:

- [JollysFastVNC](#): This is the most smartly-designed VNC client I have ever used, and it's a real must-have. But why would you want a VNC client if you're an average Mac user? Simple: to take advantage of Mac OS X's elegant "Screen Sharing" capabilities that allow you to use one Mac from the screen of another. JollysFastVNC provides this with greater speed, elegance and configurability than any other VNC client for the Mac platform - period. If you have a desire to use a distant Mac from your desktop, then this is the tool of choice, bar none.
- [WeatherDock](#): While lacking Meteorologist's sophisticated notification capabilities, WeatherDock is my weather tracking program of choice. It is simply the most customizable and elegant weather notification application available for Mac OS X, and it's free, to boot.
- [Skim](#): Another remarkable piece of free software, Skim is undoubtedly the best PDF reader for Mac OS X. Its incredible user interface makes reading and navigating PDFs a breeze (including a nifty "loupe" control that enables you to click on a portion of a PDF to read small details without having to change the magnification of the whole document). Built-in annotation and customization tools round out the package nicely. It's one of the best new free things you can download for your Mac . . . a true must-have.
- [Internet Config](#): If you're using a version of Mac OS prior to OS 9, you essentially **require** Internet Config to eliminate the headache of typing in all of your Internet-related preferences into every application you use - it's as simple as that.

Also See . . .

Can't find what you're looking for? Try a search:

Also, if you have an older Mac, be sure to check out the "[Classic](#)" applications page for more options.

Finally, take a look at [ALEMIA](#) if you think you know that name of an application, but aren't quite sure.

Other Sites Worth Visiting

If you're having problems with a piece of Mac hardware or software (or with Apple's latest system update), author Ted Landau's [MacFixIt](#) is the only place you need to go.

Traditionally, Mac OS has been a fairly secure operating system. Mac OS X, however, introduced a UNIX underpinning that is more vulnerable to security holes than Mac users are accustomed to. Two sites are worth bookmarking to keep on top of the state of your Mac's security: Apple's very own [security updates site](#) and the [SecureMac.com](#) web site, which features regular articles on potential security vulnerabilities Mac users should be aware of. For more information on all computing platforms,



BLAYK, BONZE ANNE ROSE
A00082793308 M000597460
05/01/1956 60 F
Ehmke, Clifford BSU 202-01

however, no site is more important than the [CERT](#) (formerly the Computer Emergency Response Team) web site at Carnegie Mellon University.

For the latest scoop on what's happening in the world of Macintosh, there is a triumvirate of sites that, together, will keep you truly current: Ric Ford's inimitable [MacInTouch](#); the nicely-designed and complete [MacCentral](#); and [MacNN](#), which has become a Mac news powerhouse, covering rumors, tips, and stories relating to the Mac community at large.

[Chat & Talk](#) • [Classics](#) • [Connectivity](#) • [Email](#) • [File Transfer](#) • [Helpers](#) • [MUSH/MUD](#) • [Network](#)
[Older Protocols](#) • [Other](#) • [RSS](#) • [Server](#) • [Sharing](#) • [Terminal](#) • [Usenet](#) • [Web Browsers](#)

The [Mac Orchard](#) design and content © 1995-2010 by [Drew D. Saur](#)



BLAYK, BONZE ANNE ROSE
A00082793308 M000597460
05/01/1956 60 F
Ehmke, Clifford BSU 202-01

CORNELL UNIVERSITY
 Kevin Eric Saunders
 Network Programmer/Analyst
 Network System Services
 Cornell Information Technologies
 Division of Network Resources
 633A Corson Hall
 Ithaca, NY 14853-2602

AnneRose Blayk
 AR/SE/owner
 Telephone: 607/255-6855
 Facsimile: 607/255-3771
 Electronic Mail Address: kers@cornell.edu



UNITED STATES DEPARTMENT OF COMMERCE
 BUREAU OF EXPORT ADMINISTRATION
 WASHINGTON, D.C. 20230

APPLICATION REVIEWED BY THE NSA AND FBI

08/21/2001
 CCATS #: G021989
 PAGE NO: 1

DATABEAST, INC
 ATTN: KEVIN ERIC SAUNDERS
 1668 TRUMANSBURG ROAD
 ITHACA, NY 14850-9213

databeast, inc.
 network software systems

1668 Trumansburg Road
 Ithaca, NY 14850-9213
 607-277-5808

Kevin Eric Saunders aka/anne rose blayk
 President kers@cornell.edu

The following information is in response to your inquiry of 07/02/2001 requesting licensing information for:

Item	Export Control Classification Number and Paragraph	License Exceptions Available	Country Chart Column (reason for control)	LVS Dollar Value Limit
1) DATACOMET-SECURE FOR MACINTOSH OFFERS TELNET/TN3270 (KERBEROS 5 AUTHENTICATION) OR SECURE SHELL (SSHI/SSH2) CONNECTIONS. DATA MAY BE COMPRESSED (ZLIB) AND ENCRYPTED USING 56-BIT DES, 168-BIT 3-DES, OR 128-BIT BLOWFISH ALGORITHMS.	5D002 (C.1)	ENC	NS1 AT1 National Security & Anti-Terrorism	
MODEL NUMBER: DATACOMET-SECURE 5.0				
COMMENTS FROM LICENSING OFFICER: ITEM #1: THIS ENCRYPTION ITEM IS ELIGIBLE FOR LICENSE EXCEPTION ENC UNDER SECTIONS 740.17(B)(3) OF THE EXPORT ADMINISTRATION REGULATIONS				
- reasons for control - of dataComet-Secure				

See the other side of this form for information on determining which countries require a license for the above items. For Shipments to these destinations, an export license is required from the Bureau of Export Administration.

Items otherwise eligible for export or reexport under a License Exception or NLR (no license required) and used in the design, development, production or use of nuclear, chemical or biological weapons or missiles require a license for export or reexport as provided in part 744 of the Export Administration Regulations (EAR).

NORMAN LACROIX
 DIVISION DIRECTOR

FOR INFORMATION CONCERNING
 THIS CLASSIFICATION CONTACT
 LYNNE-MARIE GRIFFIN
 PHONE #: (202) 482-5725
 BXA/STC/IT

FORM BXA-8002 (REV. 7-98)



Commerce Control List Overview and the Country Chart

Supplement No. 1 to Part 738-page 1

BLAYK, BONZE ANNE ROSE
 A00082793308 M000597460
 05/01/1956 60 F
 Ehmke, Clifford BSU 202-01

Commerce Country Chart

Reason for Control

Countries	Chemical & Biological Weapons			Nuclear Nonproliferation		National Security		Missile Tech	Regional Stability		Firearms Convantio n	Crime Control			Anti-Terrorism	
	CB	CB	CB	NP	NP	NS	NS	MT	RS	RS	FC	CC	CC	CC	AT	AT
	1	2	3	1	2	1	2	1	1	2	1	1	2	3	1	2
Afghanistan	X	X	X	X		X	X	X	X	X		X		X		
Albania	X	X		X		X	X	X	X	X		X	X			
Algeria	X	X		X		X	X	X	X	X		X		X		
Andorra	X	X		X		X	X	X	X	X		X		X		

CORNELL UNIVERSITY
 Kevin Eric Saunders
 Network Program/Analyst
 Network System Services
 Cornell Information Technologies
 Division of Network Resources
 8323 L. Johnson Hall
 Ithaca, NY 14853-2602

— now known as —
AnneRose Blayk
 ANSCorps
 Telephone: 607-255-4421
 Facsimile: 607-255-4770
 E-mail: arblayk@cornell.edu



UNITED STATES DEPARTMENT OF COMMERCE
 BUREAU OF EXPORT ADMINISTRATION
 WASHINGTON, D.C. 20230

APPLICATION REVIEWED BY THE NSA AND FBI

08/21/2001
 CCATS #: G021989
 PAGE NO: 1

DATEBASE, INC
 ATTN: KEVIN ERIC SAUNDERS
 1668 TRUMANSBURG ROAD
 ITHACA, NY 14850-9213

database, inc.
 network software systems

1668 Trumansburg Road
 Ithaca, NY 14850-9213
 607-277-5828

Kevin Eric Saunders a/k/a bonze blayk
 President kesf@cornell.edu

The following information is in response to your inquiry of 07/02/2001 requesting licensing information for:

Item	Export Control Classification Number and Paragraph	License Exceptions Available	Country Chart Column (Reason for control)	LVS Dollar Value Limit
1) DATACOMET-SECURE FOR MACINTOSH OFFERS TELNET/TN3270 (KERBEROS 5 AUTHENTICATION) OR SECURE SHELL (SSH1/SSH2) CONNECTIONS. DATA MAY BE COMPRESSED (ZLIB) AND ENCRYPTED USING 56-BIT DES, 168-BIT 3-DES, OR 128-BIT BLOWFISH ALGORITHMS.	5D002 (C.1)	ENC	NSI AT1 National Security & Anti-Terrorism - reasons for control - of dataComet-Secure	
MODEL NUMBER: DATACOMET-SECURE 5.0				
COMMENTS FROM LICENSING OFFICER:				
ITEM #1: THIS ENCRYPTION ITEM IS ELIGIBLE FOR LICENSE EXCEPTION ENC UNDER SECTIONS 740.17(B)(3) OF THE EXPORT ADMINISTRATION REGULATIONS				

See the other side of this form for information on determining which countries require a license for the above items. For Shipments to these destinations, an export license is required from the Bureau of Export Administration.

Items otherwise eligible for export or reexport under a License Exception or NLR (no license required) and used in the design, development, production or use of nuclear, chemical or biological weapons or missiles require a license for export or reexport as provided in part 744 of the Export Administration Regulations (EAR).

NORMAN LACROIX
 DIVISION DIRECTOR

FOR INFORMATION CONCERNING
 THIS CLASSIFICATION CONTACT
 LYNNE-MARIE GRIFFIN
 PHONE #: (202) 482-5725
 BXA/STC/IT

FORM BXA-6002(IRE) 7-96



Commerce Control List Overview and the Country Chart

Supplement No. 1 to Part 738—page

BLAYK, BONZE ANNE ROSE
 A00082793308 M000597460
 05/01/1956 60 F
 Ehmke, Clifford BSU 202-01

Commerce Country Chart

Reason for Control

Countries	Chemical & Biological Weapons			Nuclear Nonproliferation		National Security		Missile Tech	Regional Stability		Firearms Convention	Crime Control			Anti-Terrorism	
	CB 1	CB 2	CB 3	NP 1	NP 2	NS 1	NS 2	MT 1	RS 1	RS 2	FC 1	CC 1	CC 2	CC 3	AT 1	AT 2
	Afghanistan	X	X	X	X		X	X	X	X	X		X		X	
Albania	X	X		X		X	X	X	X	X		X	X			
Algeria	X	X		X		X	X	X	X	X		X		X		
Andorra	X	X		X		X	X	X	X	X		X		X		

Room: 243 Stay: 12/02-12/04 Weekday
 Name: BLAYK, BONZE Weekend 79.00

Meadow Court Inn

529 S. Meadow St
 Ithaca, NY 14850

GUEST INFORMATION

Full Name
BONZE BLAYK
 Address

*1668 Truansburg Rd.
 Ithaca, NY 14850*

STAY INFORMATION

Check In	Check Out	Adults/Child
12/02/2016 Fri	12/04/2016 Sun	1/0

Weekday	Weekend	Tax Exempt
	79.00	No

Folio #	Room/Room Type
29613	243 (Standard 2 Doubles)

OTHER INFORMATION

Payment Information

CCD XXXXXXXXXXXXX1148 XX/XX

Key Deposit: Phone Deposit: Room Deposit: # of keys:

TOTAL STAY INFORMATION

Total Room:	158.00
Other Charges:	0.00
Total Tax:	20.54
Total Stay:	178.54
Payments:	-178.54
Balance Due:	0.00

PLEASE NOTE that all guestrooms at the Meadow Court Inn are non-smoking. By signing this registration form you acknowledge that if you, or anyone in your guest room smokes, there will be up to a \$250.00 cleaning fee billed to your account.

If there are any damages to the furniture, or items are missing from your guestroom, you will be held liable and billed for the repair and/or replacement of these items.

The hotel does allow pets in the building with an exterior entrance to the guestrooms so advise the Front Desk Agent if this applies to you so we can ensure all procedures are followed properly to ensure the safety of your pet.

Thank you and enjoy your stay.

Bonze Blayk
 Signature: _____

Printed: 12/02/2016 at 09:47 PM

 BLAYK, BONZE ANNE ROSE
 A00082793308 M000597460
 01/01/1956 60 F
 Clifford BSU 202-01



337 Elmira Road • Ithaca, NY 14850
Phone (607) 277-5500 • Fax (607) 277-5700



name BONZE ANNE ROSE address 1668 TRUMANSBURG RD ITHACA NY 14850 UNITED STATES OF AMERICA	room number: 402/SXQL arrival date: 12/5/2016 5:00:00 AM departure date: 12/12/2016 11:01:00 AM adult/child: 1/0 room rate: 119.00	If the debit/credit card you are using for check-in is attached to a bank or checking account, a hold will be placed on the account for the full anticipated dollar amount to be owed to the hotel, including estimated incidentals, through your date of check-out and such funds will not be released for 72 business hours from the date of check-out or longer at the discretion of your financial institution.
---	--	---

Confirmation Number: 88356800

12/12/2016

Rate Plan: LV4
HH #
AL:
Car:

Rates subject to applicable sales, occupancy, or other taxes. Please do not leave any money or items of value unattended in your room. A safety deposit box is available for you in the lobby. I agree that my liability for this bill is not waived and agree to be held personally liable in the event that the indicated person, company or association fails to pay for any part or the full amount of these charges. In the event of an emergency, I, or someone in my party require special evacuation assistance due to a physical disability. Please indicate yes by checking here:

signature: _____

date	reference	description	amount
12/5/2016	657703	GUEST ROOM	\$119.00
12/5/2016	657703	OCCUPANCY TAX	\$5.95
12/5/2016	657703	STATE TAX	\$9.52
12/6/2016	657807	GUEST ROOM	\$119.00
12/6/2016	657807	OCCUPANCY TAX	\$5.95
12/6/2016	657807	STATE TAX	\$9.52
12/7/2016	657935	GUEST ROOM	\$119.00
12/7/2016	657935	OCCUPANCY TAX	\$5.95
12/7/2016	657935	STATE TAX	\$9.52
12/8/2016	658044	GUEST ROOM	\$119.00
12/8/2016	658044	OCCUPANCY TAX	\$5.95
12/8/2016	658044	STATE TAX	\$9.52
12/9/2016	658153	GUEST ROOM	\$119.00
12/9/2016	658153	OCCUPANCY TAX	\$5.95
12/9/2016	658153	STATE TAX	\$9.52
12/10/2016	658260	GUEST ROOM	\$119.00
12/10/2016	658260	OCCUPANCY TAX	\$5.95
12/10/2016	658260	STATE TAX	\$9.52
12/11/2016	658348	GUEST ROOM	\$119.00
12/11/2016	658348	OCCUPANCY TAX	\$5.95
12/11/2016	658348	STATE TAX	\$9.52
12/12/2016	658383	MC *1148	(\$941.29)
		BALANCE	\$0.00

BLAYK, BONZE ANNE ROSE
A00082793308 M000597460
05/01/1956 60 F
Ehmke, Clifford BSU 202-01

for reservations call 1.800.hampton or visit us online at hampton.com

thanks.

account no. MC *1148	date of charge 12/12/2016	folio/check no. 235570 A
card member name BLAYK, BONZE ANNE ROSE	authorization 264269	initial
establishment no. and location	establishment agrees to transmit to card holder for payment	
	purchases & services	
	taxes	
	tips & misc.	
signature of card member X	total amount	-941.29



337 Elmira Road • Ithaca, NY 14850
Phone (607) 277-5500 • Fax (607) 277-5700



BLAYK, BONZE ANNE ROSE 1605 TRUMANSBURG RD ITHACA NY 14850 UNITED STATES OF AMERICA	name address	room number: 402/SXQL arrival date: 12/5/2016 5:00:00 AM departure date: 12/12/2016 11:01:00 AM adult/child: 1/0 room rate: 119.00	If the debit/credit card you are using for check-in is attached to a bank or checking account, a hold will be placed on the account for the full anticipated dollar amount to be owed to the hotel, including estimated incidentals, through your date of check-out and such funds will not be released for 72 business hours from the date of check-out or longer at the discretion of your financial institution.
--	-----------------	--	---

Confirmation Number: 88356800 12/12/2016	Rate Plan: LV4 HH # AL: Car:
---	---------------------------------------

Rates subject to applicable sales, occupancy, or other taxes. Please do not leave any money or items of value unattended in your room. A safety deposit box is available for you in the lobby. I agree that my liability for this bill is not waived and agree to be held personally liable in the event that the indicated person, company or association fails to pay for any part or the full amount of these charges. In the event of an emergency, I, or someone in my party require special evacuation assistance due to a physical disability. Please indicate yes by checking here:

signature:

date	reference	description				amount
EXPENSE REPORT SUMMARY						
		12/5/2016	12/6/2016	12/7/2016	12/8/2016	
ROOM AND TAX		\$134.47	\$134.47	\$134.47	\$134.47	
DAILY TOTAL		\$134.47	\$134.47	\$134.47	\$134.47	
EXPENSE REPORT SUMMARY						
		12/9/2016	12/10/2016	12/11/2016	STAY TOTAL	
ROOM AND TAX		\$134.47	\$134.47	\$134.47	\$941.29	
DAILY TOTAL		\$134.47	\$134.47	\$134.47	\$941.29	

 BLAYK, BONZE ANNE ROSE
 A00082793308 M000597460
 05/01/1956 60 F
 Ehmke, Clifford BSU 202-01

for reservations call **1.800.hampton** or visit us online at **hampton.com**

thanks.

account no. MC *1148	date of charge 12/12/2016	folio/check no. 235570 A
card member name BLAYK, BONZE ANNE ROSE	authorization 264269	initial
establishment no. and location	establishment agrees to transmit to card holder for payment	
	purchases & services	
	taxes	
	tips & misc.	
signature of card member X	total amount	-941.29



130 East Seneca Street • Ithaca, NY 14850
 Phone (607) 277-8900 • Fax (607) 277-8910
 Reservations
 www.ithaca.gardeninn.com or 1 877 STAY HGI

Name & Address

K. BONZE

Room 634/Q2
 Arrival Date 12/12/2016 2:09:00 PM
 Departure Date 12/18/2016

Adult/Child 0/0
 Room Rate 169.00

Rate Plan: LV8
 HH #
 AL:
 Car:

Confirmation Number: *****

12/17/2016



BLAYK, BONZE ANNE ROSE
 A00082793308 M000597460
 05/01/1956 60 F
 Ehmke, Clifford BSU 202-01

DATE	DESCRIPTION	ID	REF. NO	CHARGES	CREDITS	BALANCE
12/12/2016	GUEST ROOM	XBODINE	1257558	\$169.00		
12/12/2016	STATE TAX	XBODINE	1257558	\$6.76		
12/12/2016	LOCAL TAX	XBODINE	1257558	\$6.76		
12/12/2016	OCCUPANCY TAX	XBODINE	1257558	\$8.45		
12/13/2016	juice	XBODINE	1257679	\$1.85		
12/13/2016	MISC -STATE AND LOCAL TAX	XBODINE	1257679	\$0.15		
12/13/2016	juice	XBODINE	1257680	\$1.85		
12/13/2016	MISC -STATE AND LOCAL TAX	XBODINE	1257680	\$0.15		
12/13/2016	stouffers	XBODINE	1257681	\$5.00		
12/13/2016	GUEST ROOM	MB	1257843	\$169.00		
12/13/2016	STATE TAX	MB	1257843	\$6.76		
12/13/2016	LOCAL TAX	MB	1257843	\$6.76		
12/13/2016	OCCUPANCY TAX	MB	1257843	\$8.45		
12/14/2016	2 Snapple	MSTONE	1258079	\$1.85		
12/14/2016	MISC -STATE AND LOCAL TAX	MSTONE	1258079	\$0.15		
12/14/2016	2 Juice	MSTONE	1258080	\$3.70		
12/14/2016	MISC -STATE AND LOCAL TAX	MSTONE	1258080	\$0.30		
12/14/2016	3 K-cups	MSTONE	1258081	\$1.25		
12/14/2016	GUEST ROOM	MB	1258112	\$169.00		
12/14/2016	STATE TAX	MB	1258112	\$6.76		
12/14/2016	LOCAL TAX	MB	1258112	\$6.76		

F
O
L
I
O

ACCOUNT NO.	DATE OF CHARGE	FOLIO NO./CHECK NO. 294447 A
CARD MEMBER NAME	AUTHORIZATION	INITIAL
ESTABLISHMENT NO. & LOCATION THANK YOU FOR STAYING AT THE HILTON GARDEN INN DOWNTOWN ITHACA. THIS RECEIPT IS FOR YOU TO KEEP AND ZIP OUT!	PURCHASES & SERVICES	
	TAXES	
	TIPS & MISC.	
	TOTAL AMOUNT	

MERCHANDISE AND/OR SERVICES PURCHASED ON THIS CARD SHALL NOT BE REBILLED OR RETURNED FOR A CASH REFUND.

PAYMENT DUE UPON RECEIPT



Hilton Garden Inn®

Ithaca

130 East Seneca Street • Ithaca, NY 14850
 Phone (607) 277-8900 • Fax (607) 277-8910
 Reservations
 www.ithaca.gardeninn.com or 1 877 STAY HGI

Name & Address

BLAYK, BONZE

Room 634/Q2
 Arrival Date 12/12/2016 2:09:00 PM
 Departure Date 12/18/2016

Adult/Child 0/0
 Room Rate 169.00

Rate Plan: LV8
 HH #
 AL:
 Car:



BLAYK, BONZE ANNE ROSE
 A00082793308 M000597460
 05/01/1956 60 F
 Ehmke, Clifford BSU 202-01

Confirmation Number: *****

12/17/2016

DATE	DESCRIPTION	ID	REF. NO	CHARGES	CREDITS	BALANCE
12/14/2016	OCCUPANCY TAX	MB	1258112	\$8.45		
12/15/2016	GUEST ROOM	MB	1258362	\$169.00		
12/15/2016	STATE TAX	MB	1258362	\$6.76		
12/15/2016	LOCAL TAX	MB	1258362	\$6.76		
12/15/2016	OCCUPANCY TAX	MB	1258362	\$8.45		
12/16/2016	*GREAT AMERICAN GRILL	LINTR	1258472	\$12.25		
12/16/2016	GUEST ROOM	MB	1258596	\$169.00		
12/16/2016	STATE TAX	MB	1258596	\$6.76		
12/16/2016	LOCAL TAX	MB	1258596	\$6.76		
12/16/2016	OCCUPANCY TAX	MB	1258596	\$8.45		
12/17/2016	*GREAT AMERICAN GRILL	LINTR	1258745	\$7.50		
12/17/2016	juice	MIKAELAST OREY	1258785	\$3.70		
12/17/2016	MISC -STATE AND LOCAL TAX	MIKAELAST OREY	1258785	\$0.30		
12/17/2016	soda	MIKAELAST OREY	1258786	\$1.85		
12/17/2016	MISC -STATE AND LOCAL TAX	MIKAELAST OREY	1258786	\$0.15		
12/17/2016	ice cream	MIKAELAST OREY	1258787	\$3.00		
12/17/2016	stouffers	MIKAELAST OREY	1258788	\$4.00		

F
O
L
I
O

ACCOUNT NO.

CARD MEMBER NAME

ESTABLISHMENT NO. & LOCATION ESTABLISHMENT AGREES TO TRANSMIT TO CARD HOLDER FOR PAYMENT
 THANK YOU FOR STAYING AT THE HILTON GARDEN INN
 DOWNTOWN ITHACA. THIS RECEIPT IS FOR YOU TO KEEP AND ZIP OUT!

DATE OF CHARGE

FOLIO NO./CHECK NO. 294447 A

AUTHORIZATION

INITIAL

PURCHASES & SERVICES

TAXES

TIPS & MISC.

TOTAL AMOUNT

MERCHANDISE AND/OR SERVICES PURCHASED ON THIS CARD SHALL NOT BE RESOLD OR RETURNED FOR A CASH REFUND.

PAYMENT DUE UPON RECEIPT



Hilton Garden Inn®

Ithaca

130 East Seneca Street • Ithaca, NY 14850
 Phone (607) 277-8900 • Fax (607) 277-8910
 Reservations
 www.ithaca.gardeninn.com or 1 877 STAY HGI

Name & Address

BLAYK, BONZE

Room 634/Q2
 Arrival Date 12/12/2016 2:09:00 PM
 Departure Date 12/18/2016

Adult/Child 0/0
 Room Rate 169.00

Rate Plan: LV8
 HH #
 AL:
 Car:

Confirmation Number: *****

12/17/2016

 BLAYK, BONZE ANNE ROSE
 A00082793308 M000597460
 05/01/1956 60 F
 Ehmke, Clifford BSU 202-01

DATE	DESCRIPTION	ID	REF. NO	CHARGES	CREDITS	BALANCE
12/17/2016	snapple	VFIGUEROA	1258828	\$1.85		
		3				
12/17/2016	MISC -STATE AND LOCAL TAX	VFIGUEROA	1258828	\$0.15		
		3				
12/17/2016	GUEST ROOM	IMB	1258839	\$169.00		
12/17/2016	STATE TAX	IMB	1258839	\$6.76		
12/17/2016	LOCAL TAX	IMB	1258839	\$6.76		
12/17/2016	OCCUPANCY TAX	IMB	1258839	\$8.45		
	WILL BE SETTLED TO MC*1148					\$1,196.82
	EFFECTIVE BALANCE OF					\$0.00

F
O
L
I
O

ACCOUNT NO.

CARD MEMBER NAME

ESTABLISHMENT NO. & LOCATION ESTABLISHMENT AGREES TO TRANSMIT TO CARD HOLDER FOR PAYMENT
 THANK YOU FOR STAYING AT THE HILTON GARDEN INN
 DOWNTOWN ITHACA. THIS RECEIPT IS FOR YOU TO KEEP AND ZIP OUT!

DATE OF CHARGE

FOLIO NO./CHECK NO. 294447 A

AUTHORIZATION

INITIAL

PURCHASES & SERVICES

TAXES

TIPS & MISC.

TOTAL AMOUNT

MERCHANDISE AND/OR SERVICES PURCHASED ON THIS CARD SHALL NOT BE RESOLD OR RETURNED FOR A CASH REFUND.

PAYMENT DUE UPON RECEIPT

Acct. Name	Blayk, Bonze Anne Rose
No.	IN 108289
Room No.:	390



Arrival	12/18/16
Departure	12/24/16
No. Guests	1
Folio Type	Current

GUEST FOLIO

BLAYK, BONZE ANNE ROSE

 A00082793308 M000597460

 05/01/1956 60 F

 Ehmke, Clifford BSU 202-01

Bonze Anne Rose Blayk

 BAR

 1668 Trumansburg Rd

 Ithaca, NY

 14850, USA

SEQ	DATE	TRANSACTION DESCRIPTION	REF/COMMENTS	ROOM #	Q	AMOUNT	TX	S/F
1	12/18/16	Visa	Aut#: 651204/4635 92XX XXXX 6194	121	1	(168.37)	I	B
2	12/18/16	Visa	Refund/4635 92XX XXXX 6194	121	1	168.37	I	B
3	12/18/16	Room	Re: 390/Blayk, Bonze Anne Rose	390	1	149.00	N	A
		Sales Tax				11.92		
		County Tax				7.45		
4	12/19/16	Visa	Aut#: 651268/4635 92XX XXXX 6194	390	1	(168.37)	I	A
5	12/19/16	Room	Re: 390/Blayk, Bonze Anne Rose	390	1	149.00	N	A
		Sales Tax				11.92		
		County Tax				7.45		
6	12/20/16	POS Room Charge	Inv:10172-47742/47742/1/Wtr:18 Time:08:48 P	390	1	24.97	I	A
7	12/20/16	POS Room Charge		390	1	2.00	I	A
	12/20/16	POS Gratuity	Inv:10172-47742/47742/1/Wtr:18 Time:08:48 P	390	1	5.00	I	A
	12/20/16	Room	Re: 390/Blayk, Bonze Anne Rose	390	1	149.00	N	A
		Sales Tax				11.92		
		County Tax				7.45		
10	12/21/16	POS Room Charge	Inv:10178-47751/47751/1/Wtr:12 Time:10:46 A	390	1	11.97	I	A
11	12/21/16	POS Room Charge		390	1	0.96	I	A
12	12/21/16	POS Gratuity	Inv:10178-47751/47751/1/Wtr:12 Time:10:46 A	390	1	2.07	I	A
13	12/21/16	Room	Re: 390/Blayk, Bonze Anne Rose	390	1	149.00	N	A
		Sales Tax				11.92		
		County Tax				7.45		
14	12/22/16	POS Room Charge	Inv:10179-47776/47776/1/Wtr:18 Time:07:35 A	390	1	10.98	I	A
15	12/22/16	POS Room Charge		390	1	0.88	I	A
16	12/22/16	POS Gratuity	Inv:10179-47776/47776/1/Wtr:18 Time:07:35 A	390	1	2.14	I	A
17	12/22/16	Visa	Aut#: 672175/4635 92XX XXXX 6194	390	1	(566.08)	I	A
18	12/22/16	POS Room Charge	Inv:10181-47799/47799/1/Wtr:4 Time:09:44 P	390	1	11.38	I	A
19	12/22/16	POS Room Charge		390	1	0.92	I	A
20	12/22/16	POS Gratuity	Inv:10181-47799/47799/1/Wtr:4 Time:09:44 P	390	1	2.70	I	A
21	12/22/16	Room	Re: 390/Blayk, Bonze Anne Rose	390	1	149.00	N	A
		Sales Tax				11.92		
		County Tax				7.45		
22	12/23/16	POS Room Charge	Inv:10184-47806/47806/1/Wtr:12 Time:11:03 A	390	1	12.98	I	A
23	12/23/16	POS Room Charge		390	1	1.04	I	A
24	12/23/16	POS Gratuity	Inv:10184-47806/47806/1/Wtr:12 Time:11:03 A	390	1	2.10	I	A
25	12/23/16	Visa	Aut#: 775884/4635 92XX XXXX 6194	390	1	(199.49)	I	A
26	12/23/16	Room	Re: 390/Blayk, Bonze Anne Rose	390	1	149.00	N	A

I have received the goods and / or services in the amount shown heron. I agree that my liability for this bill is not waived and agree to hold personally liable in the event that the indicated person, company, or associate fails to pay for any part of the full amount of these charges. If a credit card charge, I further agree to perform the obligations set forth in the cardholder's agreement with the issuer.

X

GUEST SIGNATURE

Acct. Name	Blayk, Bonze Anne Rose
No.	IN 108289
Room No.:	390



Arrival	12/18/16
Departure	12/24/16
No. Guests	1
Folio Type	Current

GUEST FOLIO

Bonze Anne Rose Blayk
 BAR
 1668 Trumansburg Rd
 Ithaca, NY
 14850, USA

SEQ	DATE	TRANSACTION DESCRIPTION	REF/COMMENTS	ROOM #	Q	AMOUNT	TX	S/F
		Sales Tax				11.92		
		County Tax				7.45		
27	12/24/16	Visa	Aut#: 887716/4635 92XX XXXX 6194	390	1	(168.37)	I	A
28	12/24/16	POS Room Charge	Inv:10191-47825/47825/1/Wtr:18 Time:08:09 A	390	1	17.61	I	A
29	12/24/16	POS Room Charge		390	1	1.41	I	A
30	12/24/16	POS Gratuity	Inv:10191-47825/47825/1/Wtr:18 Time:08:09 A	390	1	3.00	I	A
TOTAL						22.02		

 BLAYK, BONZE ANNE ROSE
 A00082793308 M000597460
 05/01/1956 60 F
 Ehmke, Clifford BSU 202-01

I have received the goods and / or services in the amount shown heron. I agree that my liability for this bill is not waived and agree to be held personally liable in the event that the indicated person, company, or associate fails to pay for any part of the full amount of the charges. If a credit card charge, I further agree to perform the obligations set forth in the cardholder's agreement with the issuer.

X

 GUEST SIGNATURE

My residence since 1994, my home at 1668 Trumansburg Rd.
 Assessed at \$170,000, \$40,000 mortgage remaining @ 419.70/mo.
 LKRAP! & beautiful inside. Some Dayk - Jan 21, 2017.



BLAYK, BONZE ANNE ROSE
 A00082793308 M000597460
 05/01/1956 60 F
 Ehmke, Clifford BSU 202-01

darkbeast, inc. office space in STUDIO WAN.

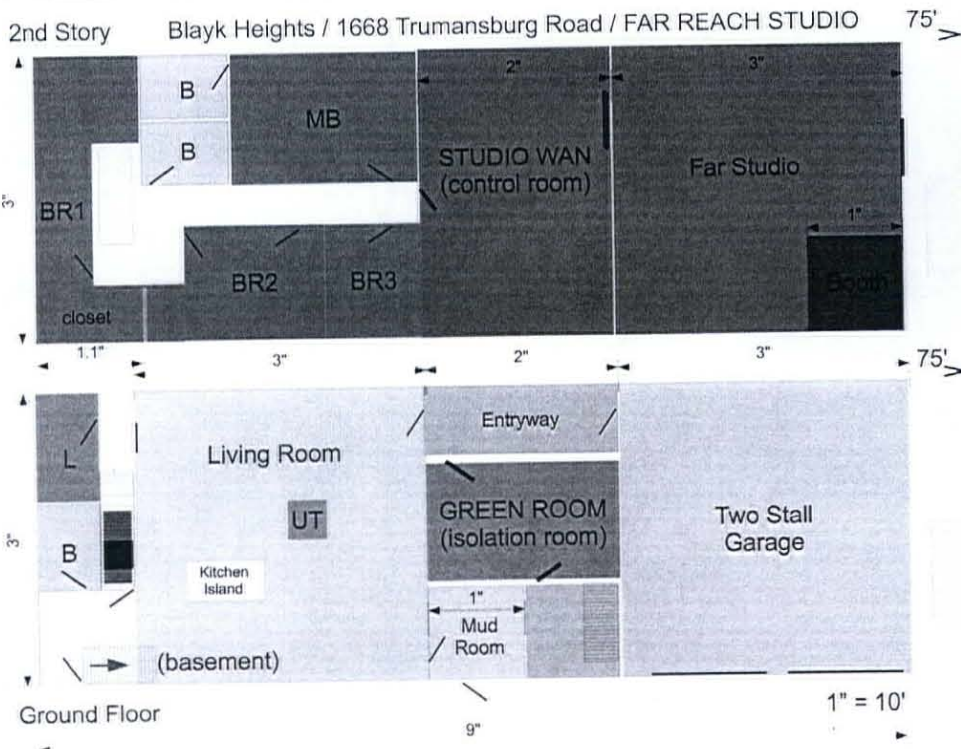

January 21, 2017

Computer code written by Anne Rose Blayk while working in my office at 1668 Trumansburg Pkwy as databaseast, Inc. - President.

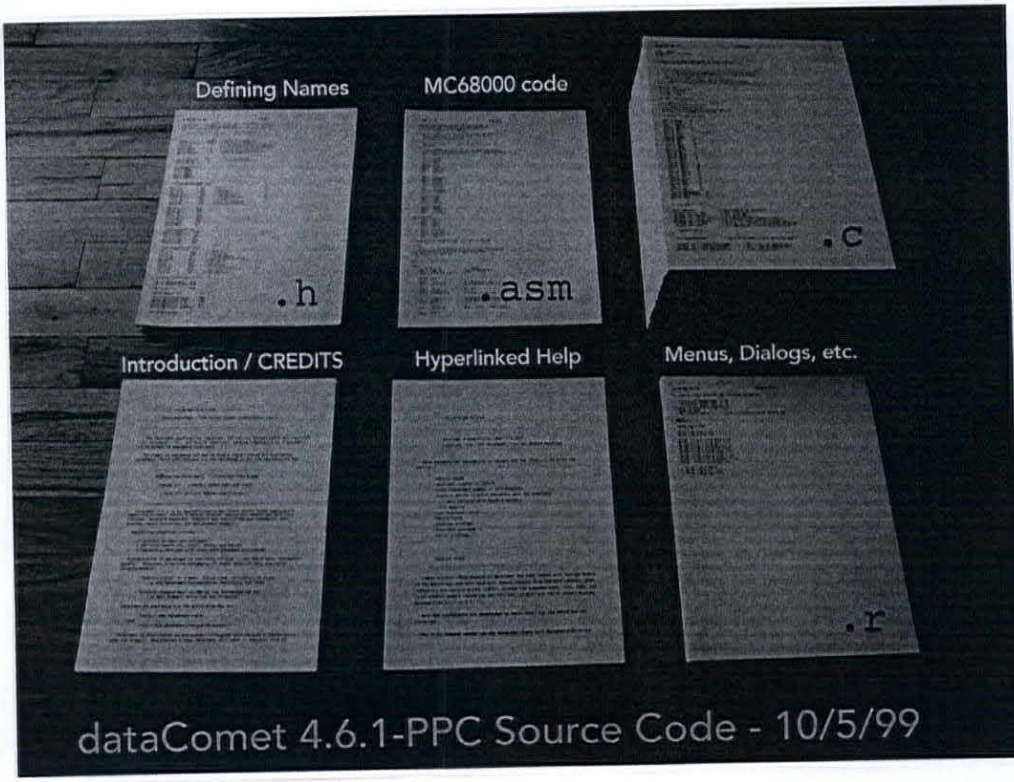

BLAYK, BONZE ANNE ROSE
A00082793308 M000597460
05/01/1956 60 F
Ehmke, Clifford BSU 202-01

> 100,000 lines of C-language code written solely by myself are incorporated in the source code for dataComet; This old printout weighs 25 pounds in total.
- Bonze Rose Blayk
- Bonze Anne Rose Blayk



